

J.E. LOVE COMPANY

LOVE®

TREE SEEDLING HARVESTER



SERIAL NUMBERS 103- 114

FORESTRY PRODUCTS GROUP

P.O. BOX 188

GARFIELD, WA 99130-0188

PHONE: (509) 635-1321

FAX: (509) 635-1434

Manufacturers of Special Harvesting Equipment

HANDLING SYSTEMS

- 5-1 -

MANUAL TRANSFER BULK HANDLING SYSTEMS, FABRIC CONVEYORS

B722000, RIGHT HAND DISCHARGE, SHOWN
B722011, LEFT HAND DISCHARGE

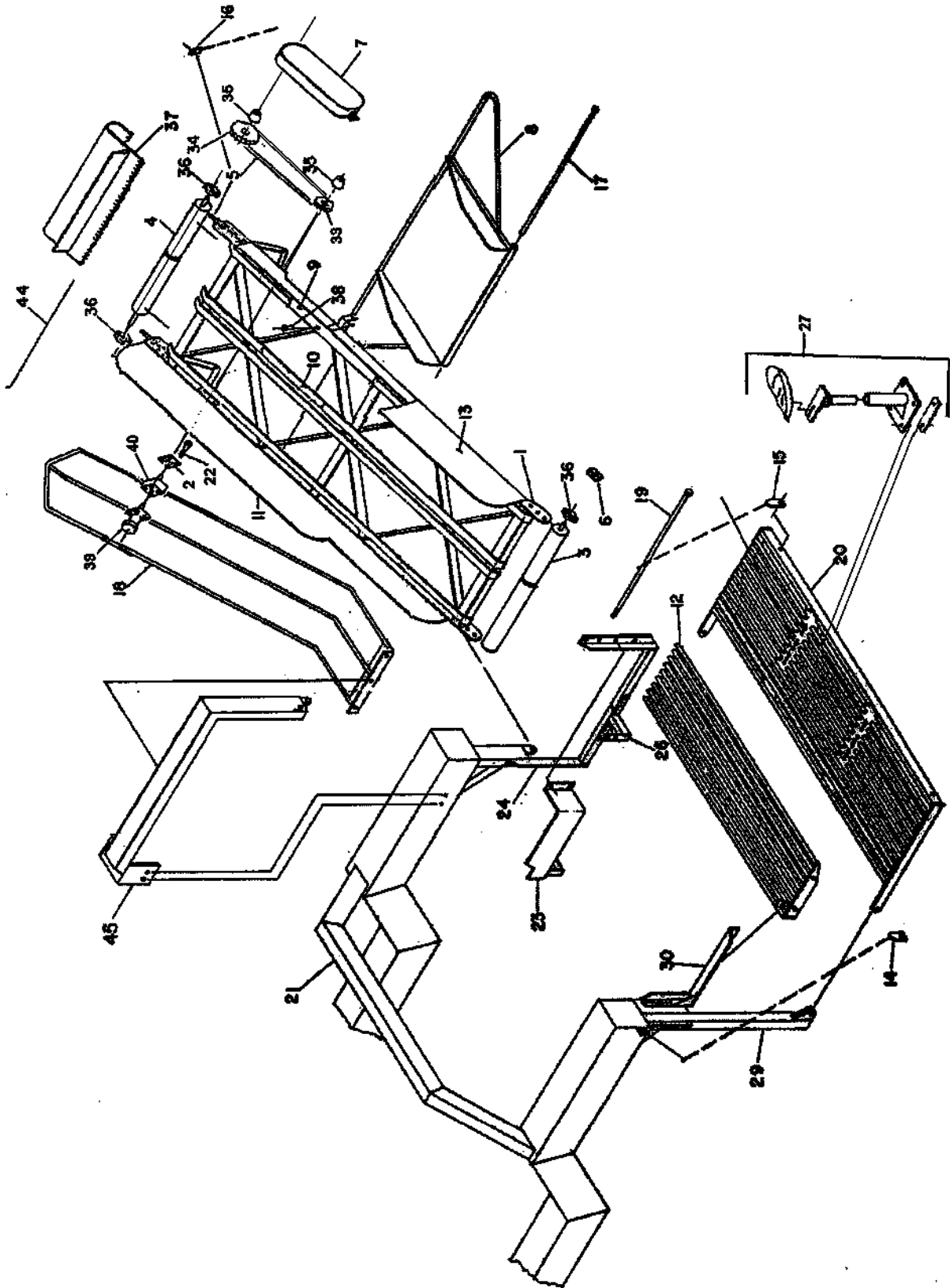

MANUAL TRANSFER BULK HANDLING SYSTEMS, FABRIC CONVEYORS
B722000, RIGHT HAND DISCHARGE, SHOWN
B722011, LEFT HAND DISCHARGE

<u>KEY</u>	<u>PART NO.</u>	<u>DESCRIPTION</u>
1	B2848	CONVEYOR EXTENSION FRAME
	B2849	BULK UNLOADING CONVEYOR FRAME - FABRIC CONVEYOR
2	B2497	MOTOR SHIM
3	B1051	IDLER PULLEY
4	B1052	DRIVE PULLEY
5	A1671	RC50 CHAIN
	B1815	OFFSET LINK
	B1816	CONNECTOR LINK
6	B1439	SPACER, BEARING
7	B2750	CHAIN GUARD, RIGHT HAND
	B2749	CHAIN GUARD, LEFT HAND
8	B1068	DISCHARGE PAN
9	B1076	WEAR STRIP, 1/8" X 4" NYLATRON GS
10	B1077	WEAR STRIP, 1/8" X 2" NYLATRON GS
11	B2748	LEFT CONVEYOR SIDE
12	B1305	RIGHT HAND TRANSVERSE GRATE
	B2707	LEFT HAND TRANSVERSE GRATE
	B2815	EXTENSION ROD (3)
	B2828	ANGLE, LH
	B2829	CONVEYOR FLAP, LH
	B2830	ANGLE, RH
	B2831	CONVEYOR FLAP, RH
	B2949	BAFFLE BOLT CLAMP
	B2954	BAFFLE, RH
	B2975	BAFFLE, LH
	B2993	GRATE EXTENSION, SIDE CONVEYOR
13	B2747	RIGHT CONVEYOR SIDE
14	B1144	LONG SUPPORT CHAIN
	B3057	CHAIN HOOK, LEFT HAND
	B3058	CHAIN HOOK, RIGHT HAND
15	B1145	SHORT SUPPORT CHAIN
16	B1148	PAN HANGER CHAIN
17	B1149	PAN HINGE PIN
18	B2564	HOLD DOWN ASSEMBLY
	B2692	HOLD DOWN MOUNT (2)
	B2693	HOLD DOWN UPPER MOUNT
	B2713	BELT CLAMP
	B2825	HOLD DOWN
	B2826	BELT HINGE
	B2827	DISCHARGE FLAP
	B2974	CHAIN, HOLD DOWN SUPPORT

**MANUAL TRANSFER BULK HANDLING SYSTEMS,
 FABRIC CONVEYORS, CONTINUED:
 B722000, RIGHT HAND DISCHARGE, SHOWN
 B722011, LEFT HAND DISCHARGE**

<u>KEY</u>	<u>PART NO.</u>	<u>DESCRIPTION</u>
19	B2647	CONVEYOR PIVOT PIN
20	B2583	LEFT HAND TRANSFER STATION ASSEMBLY
	B2584	RIGHT HAND TRANSFER STATION ASSEMBLY
21	B2439	MAIN FRAME
	B2800	76"/72" UNIVERSAL MAIN FRAME
22	X2A0370400	CAP SCREW, 3/8-16 UNC X 4
23	B2706	LEFT KNEE GUARD
	B2821	RIGHT CONVEYOR KNEE GUARD
24	B2714	TRANSFER GRATE SUPPORT
25		
26	B2710	HORIZONTAL ADJUSTMENT
27	B1591	PADDED SEAT
	B1467	CLAMP
	B1472	BASE
	B2784	SEAT PIVOT
	B2879	SPACER
	X2A0370175	3/8-16 UNC X 1-3/4 CAP SCREW
	X2C037	3/8-UNC HEX NUT
	X3B037	3/8 LOCKWASHER
	X3C037	3/8 FLAT WASHER
28		
29	NF2	TRANSFER STATION HANGER
29	B2720	TRANSFER STATION HANGER
30	B2708	RIGHT TRANSFER GRATE SUPPORT
	B2807	LEFT TRANSFER GRATE SUPPORT
31		
32		
33	B1519	SPROCKET 50 TLB 16
34	B1521	SPROCKET 50 TLB 22
35	B1522	BUSHING
36	B1664	CONVEYOR BEARING
37	B5275	CONVEYOR BELT ASSEMBLY
38	B1529	PLASTIC RIVET W/KEEPER
39	B5393	HYDRAULIC MOTOR, COUNTER CLOCKWISE - O-RING PORTS
	B5374	HYDRAULIC MOTOR, 4-BOLT ORB PORTS - PRIOR TO 1999
	B1658	HYDRAULIC MOTOR, 4-BOLT PIPE PORTS - PRIOR TO 1998
40	B1968	BEARING BLOCK (REFER TO PAGE 3-48)
41		
42		
43		

**MANUAL TRANSFER BULK HANDLING SYSTEMS,
 FABRIC CONVEYORS, CONTINUED:
 B722000, RIGHT HAND DISCHARGE
 B722011, LEFT HAND DISCHARGE, SHOWN**

<u>KEY</u>	<u>PART NO.</u>	<u>DESCRIPTION</u>
44	R10317	CLIPPER LACING WIRE X 36"
45	B2634	RIGHT CONVEYOR BEAM
	B2712	LEFT CONVEYOR BEAM
NOT SHOWN:		
	B2632	HANGER YOKE
	B2641	GUIDE BLOCK (3)
	B2687	CONVEYOR HEIGHT ADJUSTMENT SCREW
	B1588	HOSE ASSEMBLY, 3/8 X 30" (2)
	B1655	½ QUICK DISCONNECT NIPPLE - 1/2 NPTM
	B1656	½ QUICK DISCONNECT COUPLER - 1/2 NPTF
	B5095	HOSE ASSEMBLY, 3/8 X 50"
	B5096	HOSE ASSEMBLY, 3/8 X 60"
	B5182	½ QUICK DISCONNECT NIPPLE - 1/2 NPTF
	B5301	½ QUICK DISCONNECT COUPLER - 1/2 NPTM
	B5399	FLOW CONTROL VALVE, #10 SAE WITH RELIEF VALVE
	B2705	CYLINDER MOUNT (2)
	B2996	MOUNT, REAR CYLINDER
	B5547	CONVEYOR LIFT CYLINDER ASSEMBLY (2)
	B5125	VELOCITY FUSE, #8 JIC
	F1704	BREATHER, #8 ORB
	F3515	HYDRAULIC CYLINDER, 2" X 12" NPT (REFER TO PAGE 3-23)

SLING HANDLING TRAILER SYSTEM

B722001

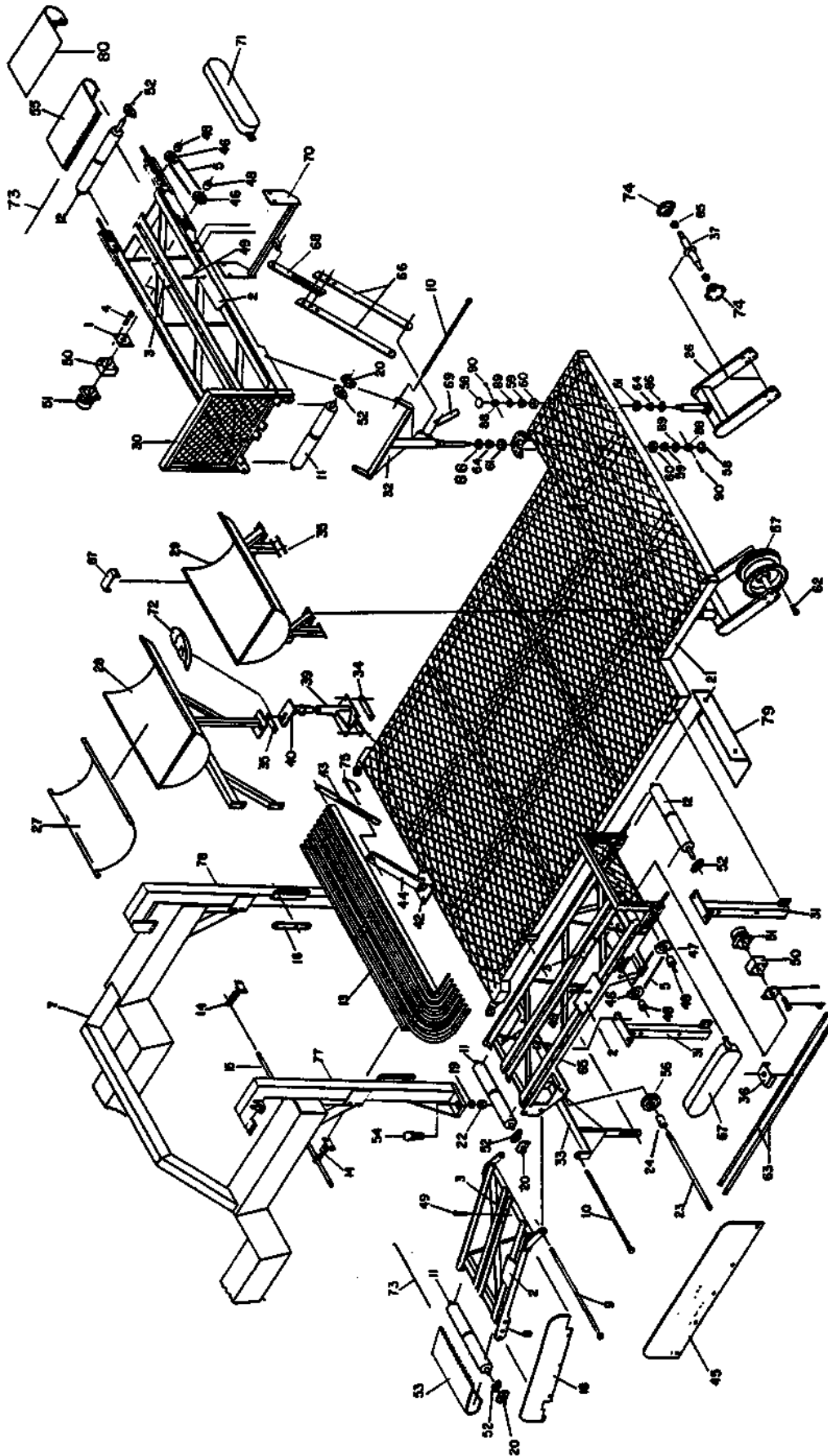

**SLING HANDLING TRAILER SYSTEM
B722001**

<u>KEY</u>	<u>PART NO.</u>	<u>DESCRIPTION</u>
1	B2497	MOTOR BLOCK SPACER
2	B1076	WIDE WEAR STRIP, 1/8" X 4"
3	B1077	NARROW WEAR STRIP, 1/8" X 2"
		SPECIFY LENGTH, UNIT = 1"
	B1529	3/4 POLYMER CSK HEAD RIVET (PKG OF 100)
4	X2A0370400	CAP SCREW, 3/8-16 UNC X 4
5	A1671	STOCK RC50 ROLLER CHAIN, BOX OF 10 FT
	B1815	OFFSET LINK
	B1816	CONNECTOR LINK
6	B2967	BRACE, UNLOADING CONVEYOR, 3 PCS, NOT SHOWN
	R10465	TUBE CLAMP
7	B2439	72" UNIVERSAL MAIN FRAME
8	B1407	INCLINED CONVEYOR FRAME
9	B1409	PIVOT PIN
10	B1410	PITCH LINK PIN
11	B1411	BELT IDLER PULLEY
12	B1412	BELT DRIVE PULLEY
13	B1420	TRANSVERSE GRATE, STD SPACING RODS
	B1420X	TRANSVERSE GRATE, NARROW SPACE RODS
14	B1421	TRANSVERSE GRATE EXTENSION
15	B1422	EXTENSION ROD
16	B1423	VERTICAL ADJUSTMENT
17	B2968	ANCHOR, REAR BRACE, NOT SHOWN
18	B1432	CONVEYOR SIDE
19	X3B125	LOCK WASHER, 1-1/4
20	B1439	BEARING SPACER
21	B2440	TRAILER FRAME
22	X2L125-NUT	HEX NUT, 1-1/4 - 12 THREAD
23	B1452	SUPPORT ROD
24	B1453	SUPPORT ROD SPACER
25	B2969	EAR, CONVEYOR BRACE, NOT SHOWN
26	B2432	FORK, TRAILER CASTER - STANDARD
27		CANVAS SLING (NOT FURNISHED)
28	B1457	FRONT BARREL
29	B1458	REAR BARREL
30	B1459	UNLOADING CONVEYOR FRAME
31	B1460	CONVEYOR SUPPORT
32	B2443	UNLOADING CONVEYOR SUPPORT AND PIVOT
33	B1463	INCLINED CONVEYOR SUPPORT

SLING HANDLING TRAILER SYSTEM, B722001, CONTINUED:

<u>KEY</u>	<u>PART NO.</u>	<u>DESCRIPTION</u>
34	B1467	PIVOTING SEAT BASE CLAMP
35	B1468	BARREL CLAMP PLATE
36	B1469	PIPE CLAMP
37	B2433	FORK AXLE
38	B2970	LOCK, CONVEYOR TRANSPORT, REAR POSITION
39	B1472	SEAT BASE
40	B2784	SEAT PIVOT
41		
42	B1489	UPRIGHT BASE
43	B1490	ADJUSTMENT ARM
44	B1491	UPRIGHT
45	B1497	CONVEYOR SIDE
46	B1519	SPROCKET, 50TLB16
47	B1521	SPROCKET, 50TLB22
48	B1522	BUSHING, 1" BORE
49	B1529	PLASTIC RIVET WITH KEEPER, PKG OF 100
50	B1968	BEARING BLOCK (REFER TO PAGE 3-48)
51	B5394	HYDRAULIC MOTOR, 4-BOLT ORB PORTS CLOCKWISE 1999 & LATER
	B5378	HYDRAULIC MOTOR, 4-BOLT ORB PORTS - PRIOR TO 1999
	B1658	HYDRAULIC MOTOR, 4-BOLT PIPE PORTS - PRIOR TO 1998
52	B1664	BEARING
53	B1665	CONVEYOR BELT, 24" X 242" O.A.L.
54	B1667	HITCH BALL, 2-5/16
55	B1668	UNLOADING CONVEYOR BELT, 24" X 175" O.A.L.
56	B1669	RUBBER TIRED IDLER
57	B1700	CASTER WHEEL AND TIRE ASSEMBLY
	B1697	WHEEL
	(*)B1771	TIRE, 20.5 X 8-10, LOAD RANGE E
	D10100	VALVE STEM ASSEMBLY
58	B1609	HUB CAP
59	B1610	UPPER WHEEL CONE
60	B1611	UPPER WHEEL CUP
61	B1613	LOWER WHEEL CUP
62	B1705	CASTER WHEEL LUG BOLT
63	B2403	PIPE, 1/2" X 104" GALVANIZED (2)
64	B1614	LOWER WHEEL CONE
65	B2405	HORIZONTAL CONVEYOR FRAME
66	B2406	DOUBLE BRACE
67	B2407	CHAIN GUARD



WARNING - SHIELDS ARE FOR YOUR PROTECTION - KEEP THEM IN PLACE!

D24 DECAL, BE CAREFUL

SLING HANDLING TRAILER SYSTEM B722001, CONTINUED

<u>KEY</u>	<u>PART NO.</u>	<u>DESCRIPTION</u>
68	B2408	SINGLE BRACE
69	X2A0370200	3/8-16 UNC X 2 CAP SCREW (LATCH)
70	B2410	OUTBOARD SUPPORT
71	B2411	UNLOADING CONVEYOR GUARD



WARNING - SHIELDS ARE FOR YOUR PROTECTION - KEEP THEM IN PLACE!

D24		DECAL, BE CAREFUL
72	B1591	PADDED SEAT WITH BACK
73	R10317	CLIPPER LACING WIRE X 36"
75	R14184	SNAPPER PIN
77	B2441	TRAILER ATTACHING LEG, LEFT
78	B2442	TRAILER ATTACHING LEG, RIGHT
79	B2415	SEEDLING STOP
80	B2416	END COVER
85	R10346	SET COLLAR, 1" ECCENTRIC
86	B1934	SPINDLE SEAL
87	B2498	SELECTOR VALVE, MOUNT
88	X2L087-SLT	HEX SLOTTED NUT, 7/8-14 UNF
89	X3C088	SAE WASHER, 7/8
90	X3A15-175	COTTER PIN, 5/32 X 1-3/4
		NOT SHOWN:
	B2949	PLATE, BAFFLE BOLT
	B2954	BAFFLE RH

TUB HANDLING TRAILER SYSTEM
B722002 & B722013

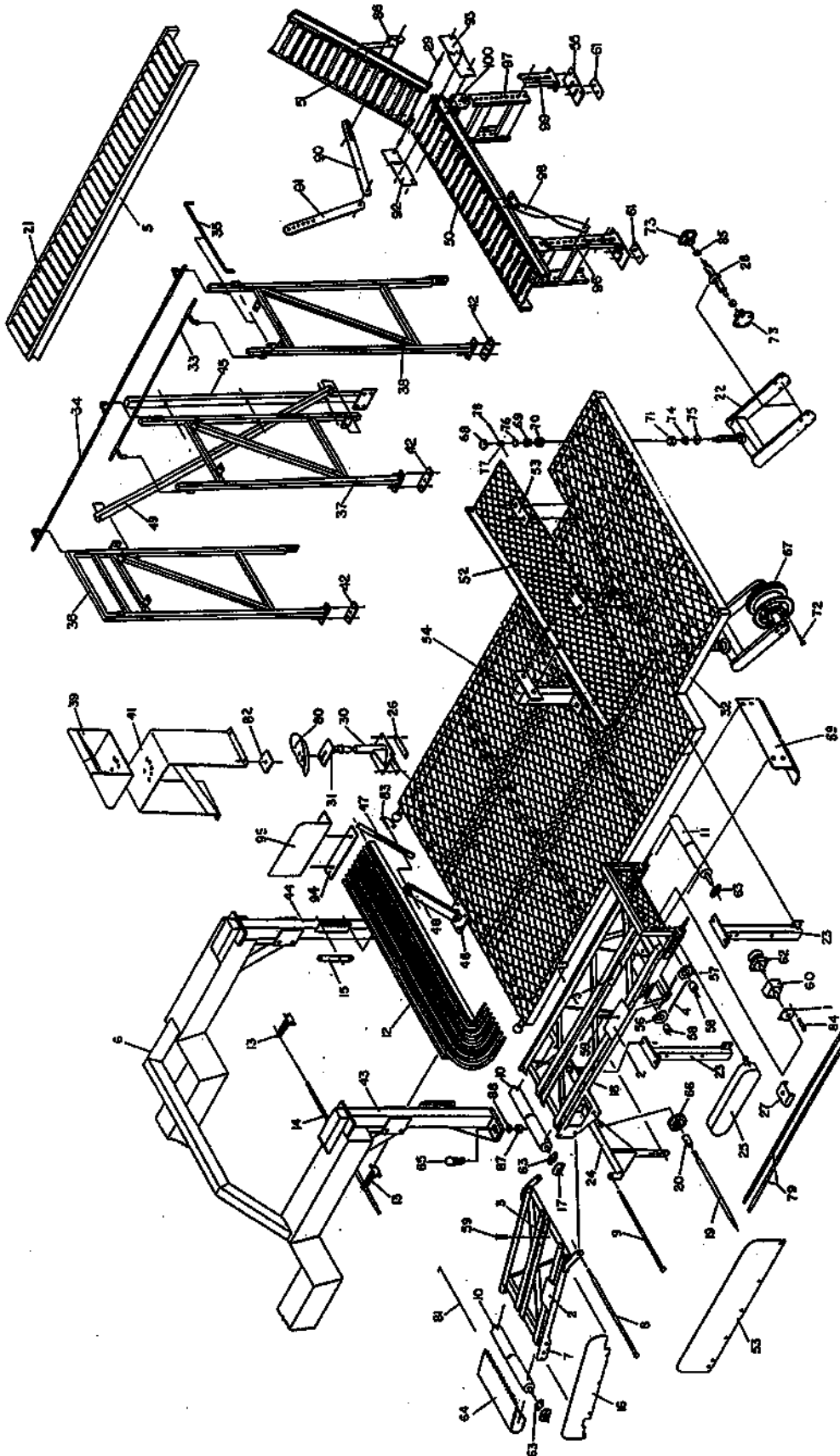

TUB HANDLING TRAILER SYSTEM
B722002, SERIAL NO.76 & LATER, B722013

<u>KEY</u>	<u>PART NO.</u>	<u>DESCRIPTION</u>
1	B2497	MOTOR BLOCK SPACER
2	B1076	WIDE (4") WEAR STRIP, SPECIFY LENGTH
3	B1077	NARROW (2") WEAR STRIP, SPECIFY LENGTH
4	A1671	STOCK RC50 ROLLER CHAIN, BOX OF 10 FT
	B1815	OFFSET LINK
	B1816	CONNECTOR LINK
5	B1772	ROLLER TRACK, 15" X 10 FT
6	B2439	72" UNIVERSAL MAIN FRAME
7	B1407	INCLINED CONVEYOR FRAME
8	B1409	PIVOT PIN
9	B1410	PITCH LINK PIN
10	B1411	BELT IDLER PULLEY
11	B1412	BELT DRIVE PULLEY
12	B1420	TRANSVERSE GRATE
13	B1421	TRANSVERSE GRATE EXTENSION
14	B1422	EXTENSION ROD (3)
15	B1423	VERTICAL ADJUSTMENT
16	B1432	CONVEYOR SIDE
17	B1439	BEARING SPACER
18	B2405	HORIZONTAL CONVEYOR FRAME
19	B1452	SUPPORT ROD
20	B1453	SUPPORT ROD SPACER
21	B1881	STRAIGHT ROLLER ONLY, 15"
22	B2432	FORK, TRAILER CASTER - STANDARD
23	B1460	CONVEYOR SUPPORT
24	B1463	INCLINED CONVEYOR SUPPORT
25	B2785	CHAIN GUARD



WARNING - SHIELDS ARE FOR YOUR PROTECTION - KEEP THEM IN PLACE!

	D24	DECAL, BE CAREFUL
26	B1467	PIVOTING SEAT BASE CLAMP
27	B1469	PIPE CLAMP (3)
28	B2433	FORK AXLE
29	B2400	SPACER (12)
30	B1472	SEAT BASE
31	B2784	SEAT PIVOT
32	B2440	TRAILER FRAME, SERIAL NO. 064 & LATER
33	B2935	MEDIUM SIDE RAIL (REAR LEFT)
34	B2936	LONG SIDE RAIL, R.H.
35	B1478	REAR RAIL (TUB STOP)
36	B2929	FORWARD CONVEYOR SUPPORT
37	B2930	CENTER CONVEYOR SUPPORT

TUB HANDLING TRAILER SYSTEM
B722002, SERIAL NO. 076 & LATER, B722013, CONTINUED

<u>KEY</u>	<u>PART NO.</u>	<u>DESCRIPTION</u>
38	B2931	REAR CONVEYOR STAND
39	B1482	TUB PLATFORM, B722002
	B2978	PLATFORM, CONTAINER, B722013
40	B1483	FORWARD TUB BASE, B722002
	B2979	BASE, B722013
41	B1497	CONVEYOR SIDE
42	B1485	CONVEYOR ATTACH PLATE (3)
43	B2441	LEFT TRAILER ATTACHING LEG
44	B2442	RIGHT TRAILER ATTACHING LEG
45	B2934	CONVEYOR SUPPORT POST (2)
46	B1489	UPRIGHT BASE
47	B1490	ADJUSTMENT ARM
48	B1491	UPRIGHT
49	B2932	DIAGONAL BRACE
50	B2937	ROLLER TRACK, 60"
51	B2938	ROLLER TRACK, 45"
52	B2939	DECK EXTENSION, GEORGIA TUB
53	B2940	PLATE, BOLT (2)
54	B2941	SUPPORT, DECK EXTENSION
55	B2942	PLATE, MOUNTING (4)
56	B1519	SPROCKET, 50TLB16
57	B1521	SPROCKET, 50TLB22
58	B1522	BUSHING, 1" BORE
59	B1529	PLASTIC RIVET WITH KEEPER, PKG OF 100
60	B1968	BEARING BLOCK (REFER TO PAGE 3-48)
61	B2943	PLATE, BOLT (2)
62	B5394	HYDRAULIC MOTOR, 4-BOLT ORB PORTS CLOCKWISE 1999 & LATER
	B5378	HYDRAULIC MOTOR, 4-BOLT ORB PORTS - PRIOR TO 1999
	B1658	HYDRAULIC MOTOR, 4-BOLT PIPE PORTS - PRIOR TO 1998
63	B1664	BEARING
64	B1665	CONVEYOR BELT, 24" X 242" O.A.L.
65	B1667	HITCH BALL, 2-5/16
66	B1669	RUBBER TIRED IDLER
67	B1700	CASTER WHEEL AND TIRE ASSEMBLY
	B1697	WHEEL
	(*)B1771	TIRE, 20.5 X 8-10, LOAD RANGE E
	D10100	VALVE STEM ASSEMBLY
68	B1609	HUB CAP
69	B1610	UPPER WHEEL CONE
70	B1611	UPPER WHEEL CUP
71	B1613	LOWER WHEEL CUP
72	B1705	CASTER WHEEL LUG BOLT

(*) REFERENCE ONLY, NOT FOR RESALE.

TUB HANDLING TRAILER SYSTEM

B722002, SERIAL NO. 076 & LATER, B722013, CONTINUED

<u>KEY</u>	<u>PART NO.</u>	<u>DESCRIPTION</u>
73	B1928	BEARING, 4-BOLT FLANGE
74	B1614	LOWER WHEEL CONE
75	B1934	SPINDLE SEAL
76	X3C088	SAE WASHER, 7/8
77	X2L087-SLT	HEX SLOTTED NUT, 7/8-14 UNF
78	X3A15-175	COTTER PIN, 5/32 X 1-3/4
79	B2403	PIPE, 1/2" X 104" GALVANIZED (2)
80	B1591	PADDED SEAT WITH BACK
81	R10317	CLIPPER LACING WIRE X 36"
82	B2402	TUB STAND CLAMP (4)
83	R14184	SNAPPER PIN
84	X2A0370400	CAP SCREW, 3/8-16 UNC X 4
85	R10346	SET COLLAR, 1" ECCENTRIC
86	B2946	BRACKET, SUPPORT
87	X2L125-NUT	HEX NUT, 1-1/4 - 12 THREAD
88	X3B125	LOCK WASHER, 1-1/4
89	B2415	SEEDLING STOP
90	B2944	BRACE, SLOTTED (2)
91	B2945	BRACE, ADJUSTING (2)
92	B2947	BRACKET, LH PIVOT
93	B2948	BRACKET, RH PIVOT
94	B2949	PLATE, BAFFLE BOLT
95	B2954	BAFFLE, RH
96	B2971	SUPPORT ASSEMBLY, ROLLER TRACK
97	B2972	SUPPORT, ROLLER CONVEYOR SHORT
98	B5319	BRACE, KNEE (4)
99	B5320	FOOT, ROLLER CONVEYOR SUPPORT (4)
100	B5326	BRACKET, ROLLER CONVEYOR SUPPORT, TOP (4)

NOT SHOWN:

B2984	HOOK, LH
B2985	HOOK, RH

HYDRAULIC SCHEMATIC, SLING HANDLING TRAILER
 B722001

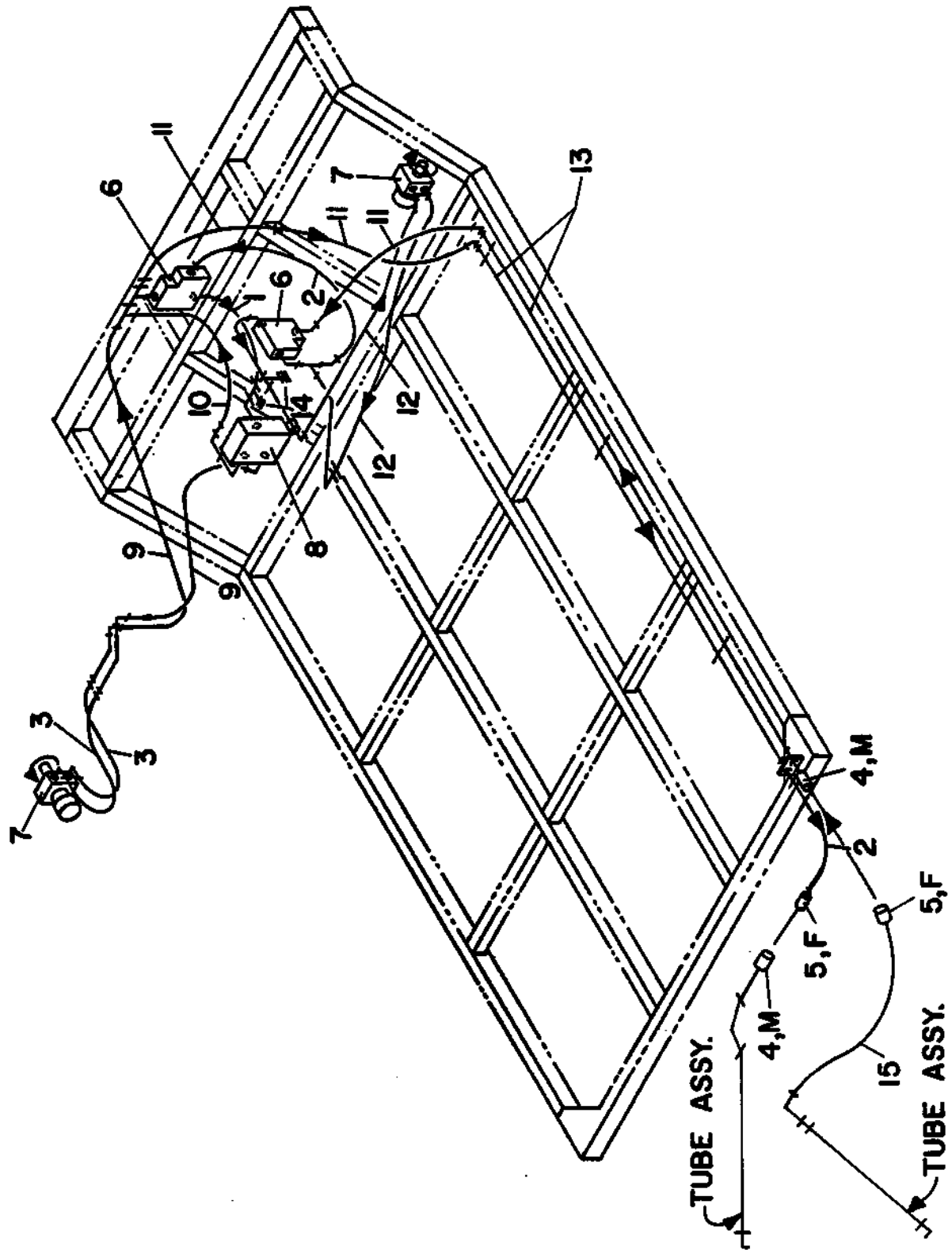

**HYDRAULIC SCHEMATIC, SLING HANDLING TRAILER
B722001**

<u>KEY</u>	<u>PART NO.</u>	<u>DESCRIPTION</u>
1	B1559	HOSE ASSEMBLY, 1/2" X 15"
2	B1560	HOSE ASSEMBLY, 1/2" X 48" (2)
32	B1561	HOSE ASSEMBLY, 3/8" X 36" (2)
4	B1655	QUICK DISCONNECT NIPPLE, 1/2"
5	B1656	QUICK DISCONNECT COUPLER, 1/2"
6	B5399	FLOW CONTROL VALVE, #10 SAE WITH RELIEF
7	B5394	HYDRAULIC MOTOR, 4-BOLT ORB PORTS CLOCKWISE 1999 & LATER
	B5378	HYDRAULIC MOTOR, 4-BOLT ORB PORTS - PRIOR TO 1999
	B1658	HYDRAULIC MOTOR, 4-BOLT PIPE PORTS - PRIOR TO 1998
8	VPH-3	SELECTOR VALVE, SAE - #8 ORB PORTS
9	B1708	HOSE ASSEMBLY, 3/8" X 60"
10	B5	HOSE ASSEMBLY, 1/2" X 22" (2)
11	F1213	HOSE ASSEMBLY, 1/2" X 30" (2)
12	B1588	HOSE ASSEMBLY, 3/8" X 30" (2)
13	B2403	PIPE, 1/2" X 104" - GALVANIZED (2)
14	B1932	TEST PORT NIPPLE
	B1936	DUST CAP
15	K1523	HOSE ASSEMBLY, 1/2" X 48"

HYDRAULIC SCHEMATIC, TUB HANDLING TRAILER

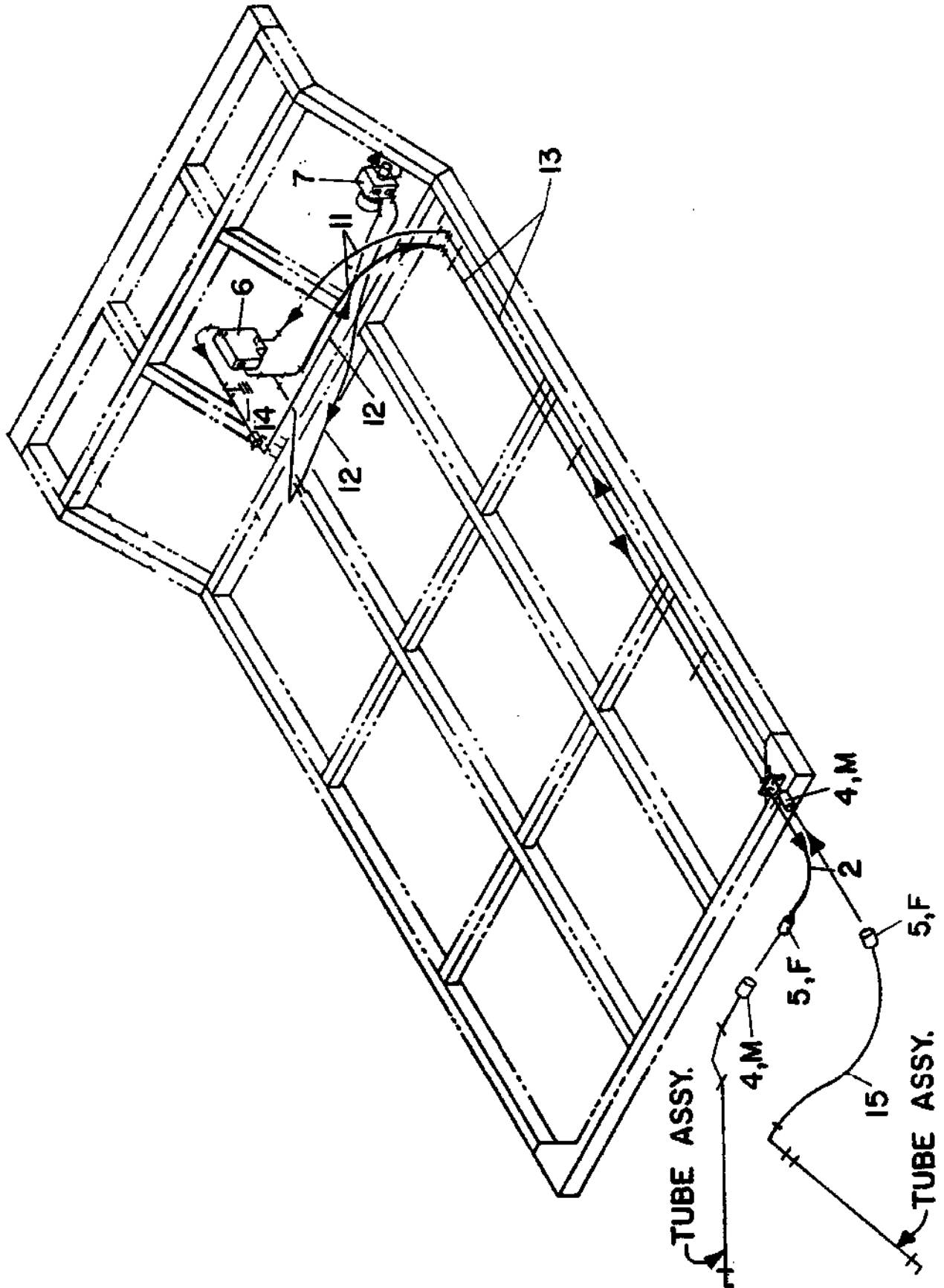

**HYDRAULIC SCHEMATIC, TUB HANDLING TRAILER
B722001 AND B722002**

<u>KEY</u>	<u>PART NO.</u>	<u>DESCRIPTION</u>
2	B1560	HOSE ASSEMBLY, 1/2" X 48"
4	B1655	QUICK DISCONNECT NIPPLE, 1/2"
5	B1656	QUICK DISCONNECT COUPLER, 1/2"
6	B1657	FLOW CONTROL VALVE
7	B5394	HYDRAULIC MOTOR, 4-BOLT ORB PORTS CLOCKWISE 1999 & LATER
	B5378	HYDRAULIC MOTOR, 4-BOLT ORB PORTS - PRIOR TO 1999
	B1658	HYDRAULIC MOTOR, 4-BOLT PIPE PORTS - PRIOR TO 1998
11	F1213	HOSE ASSEMBLY, 1/2" X 30"
12	B1588	HOSE ASSEMBLY, 3/8" X 30" (2)
13	B2403	PIPE, 1/2" X 104" - GALVANIZED (2)
14	B1932	TEST PORT NIPPLE
	B1936	DUST CAP
15	K1523	HOSE ASSEMBLY, 1/2" X 48"

STANDARD (SHORT) TRAILER CANOPY, FULL GABLE

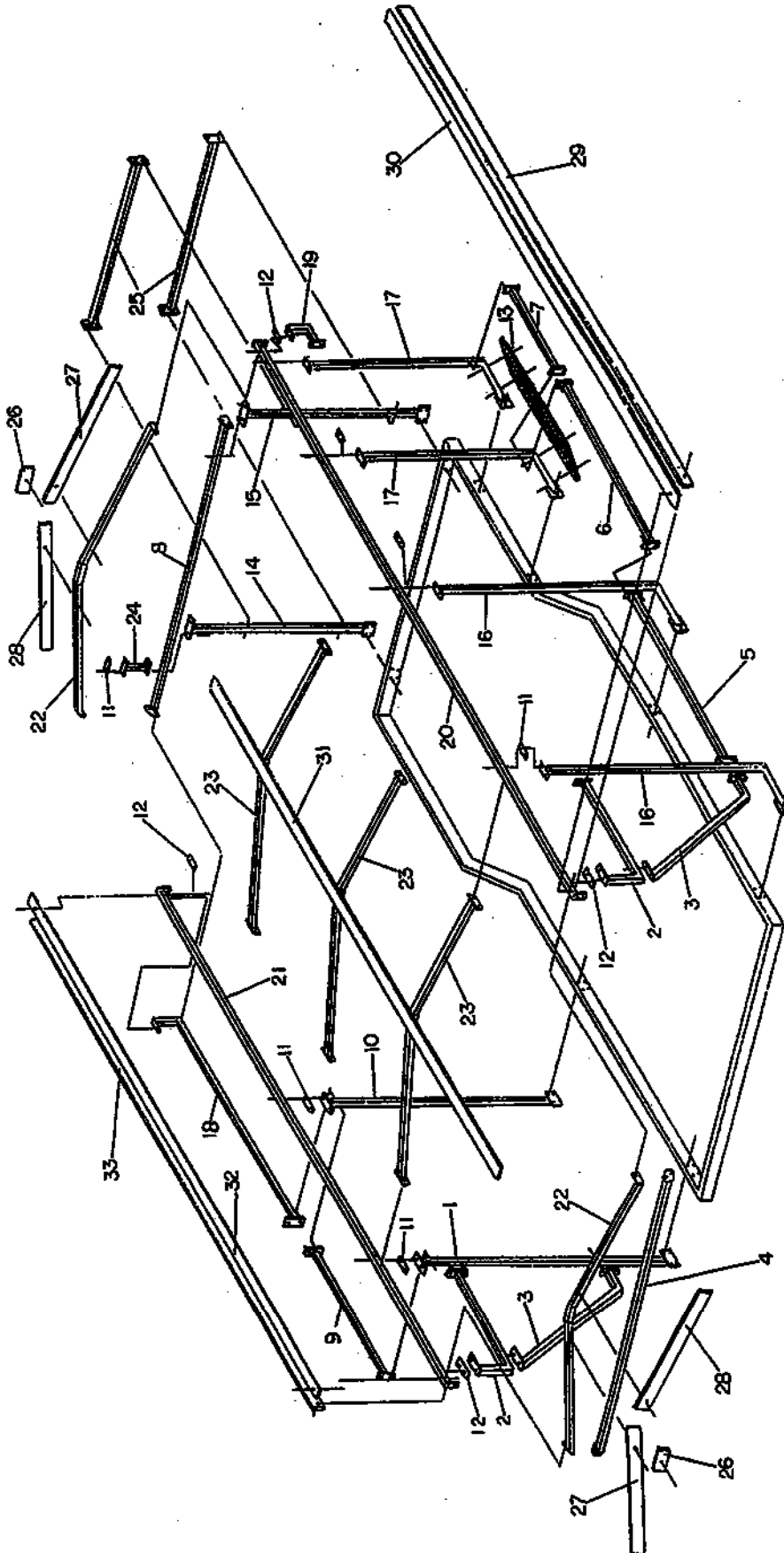

**STANDARD (SHORT) TRAILER CANOPY, FULL GABLE
B724003**

<u>KEY</u>	<u>PART NO.</u>	<u>DESCRIPTION</u>
1	B2458	LONG STRAIGHT POST
2	B2459	UPPER CORNER (2)
3	B2460	FRONT DIAGONAL (2)
4	B2463	BOTTOM FRONT CROSS MEMBER
5	B2469	BRACE, 69-3/4"
6	B2470	BRACE, 52"
7	B2471	BRACE, 33"
8	B2474	REAR LOWER CROSS MEMBER
9	B2478	BRACE, 67-1/4"
10	B2485	RIGHT MIDDLE POST
11	B2606	RUBBER SHIM, DOUBLE HOLE
12	B2607	RUBBER SHIM, SINGLE HOLE
13	B2778	DECK EXTENSION, 33"
14	B2861	RIGHT REAR POST
15	B2862	LEFT REAR POST
16	B2889	LEFT FRONT OFFSET POST (2)
17	B2890	LEFT REAR OFFSET POST (2)
18	B2891	RIGHT REAR TOP CORNER
19	B2892	LEFT REAR TOP CORNER
20	B2896	OUTSIDE TOP RAIL, LEFT
21	B2897	OUTSIDE TOP RAIL, RIGHT
22	B2898	TOP END CROSS MEMBER (2)
23	B2899	TOP CENTER CROSS MEMBER (3)
24	B2900	REAR TOP BRACE
25	B2933	BRACE. 60-1/4" (2)
26	B5510	CENTER END BOARD ASSEMBLY (2)
27	B5511	FRONT END BOARD ASSEMBLY, LH (2)
28	B5512	FRONT END BOARD ASSEMBLY, RH (2)
29	B5513	LEFT CORNER BOARD ASSEMBLY, 2 PIECES
30	B5514	LEFT TOP CORNER BOARD ASSEMBLY, 2 PIECES
31	B5515	CENTER TOP BOARD ASSEMBLY, 2 PIECES
32	B5516	RIGHT TOP CORNER BOARD ASSEMBLY, 2 PIECES
33	B5517	RIGHT CORNER BOARD ASSEMBLY, 2 PIECES

NOT SHOWN:

B5271	CANVAS COVER
B1976	CARPET STRIP, 4" WIDE, PER FOOT
B1979	CANOPY TIES, BAG OF 50

NOTE: 1999 - 2000 DESIGN CHANGE(S):

CARPET STRIPS CEMENTED TO METAL CHANNEL FOR THE TOP SUPPORTS
 CARPET STRIPS CEMENTED TO METAL ANGLE FOR THE CORNER SUPPORTS

BAG BANDING TRAILER SYSTEM, B722007

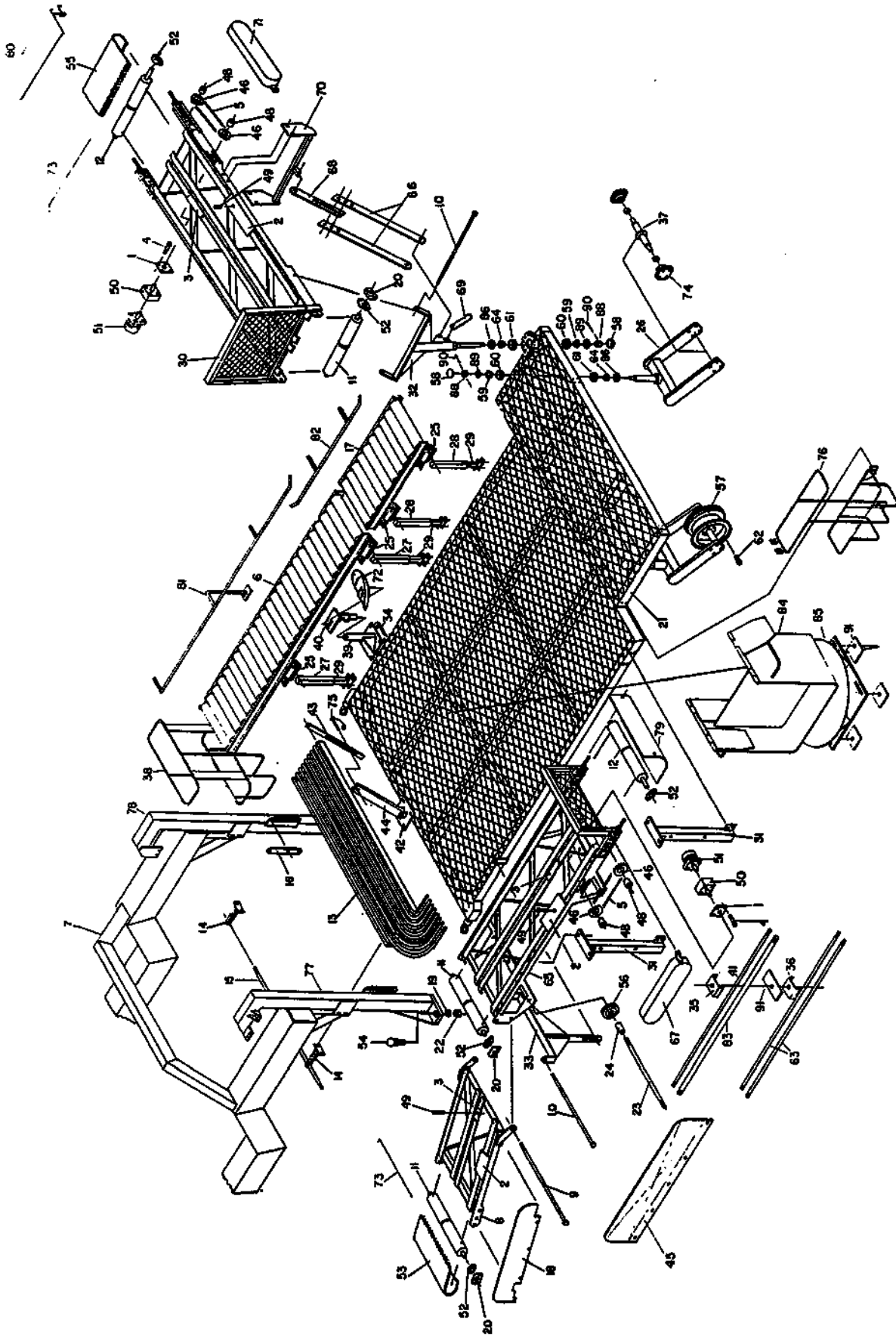

BAG BANDING TRAILER SYSTEM, B722007

<u>KEY</u>	<u>PART NO.</u>	<u>DESCRIPTION</u>
1	B2497	BEARING BLOCK SPACER
2	B1076	NYLATRON GS 1/8 X 4 WEAR STRIP (SPECIFY LENGTH, UNIT = 1")
3	B1077	NYLATRON GS 1/8 X 2 WEAR STRIP (SPECIFY LENGTH, UNIT = 1")
4	X2A0370400	CAP SCREW, 3/8-16 UNC X 4
5	A1671	RC50 ROLLER CHAIN, BOX OF 10 FT.
	B1815	OFFSET LINK
	B1816	CONNECTOR LINK
6	B2752	ROLLER TRACK, 15" X 90"
7	B2439	72" UNIVERSAL MAIN FRAME
8	B1407	INCLINED CONVEYOR FRAME
9	B1409	PIVOT PIN
10	B1410	PITCH LINK PIN
11	B1411	BELT IDLER PULLEY, 25-3/8"
12	B1412	BELT DRIVE PULLEY, 25-3/8"
13	B1420	TRANSVERSE GRATE
14	B1421	GRATE EXTENSION
15	B1422	EXTENSION ROD
16	B1423	VERTICAL ADJUSTMENT
17	B2753	ROLLER TRACK, 15" X 30"
18	B1432	INCLINED CONVEYOR SIDE
19	X3B125	LOCK WASHER, 1-1/4
20	B1439	CONVEYOR BEARING SPACER
21	B2721	BAG BANDING TRAILER FRAME
22	X2L125-NUT	HEX NUT, 1-1/4 - 12 THREAD
23	B1452	REVERSE BELT SUPPORT ROD
24	B1453	REVERSE BELT SUPPORT SPACER
25	B2754	TRACK BRACKET
26	B2432	FORK, TRAILER CASTER - STANDARD
27	B2755	LONG TRACK SUPPORT (2)
	B2915	LONG OFFSET SUPPORT (RIGHT) W/O CANOPY (2)
28	B2756	SHORT TRACK SUPPORT (2)
	B2916	SHORT OFFSET SUPPORT (RIGHT) W/O CANOPY (2)
29	B2757	CONVEYOR SUPPORT BASE
30	B1459	UNLOADING CONVEYOR FRAME
31	B1460	CONVEYOR SUPPORT
32	B2443	UNLOADING CONVEYOR PIVOT
33	B2760	INCLINED CONVEYOR SUPPORT
34	B1467	SEAT PIVOT BASE CLAMP
35	B2995	PIPE CLAMP, 3/4 X 3/4
36	B1469	PIPE CLAMP, 1/2 X 1/2
37	B2433	FORK AXLE

BAG BANDING TRAILER SYSTEM, B722007, CONTINUED:

<u>KEY</u>	<u>PART NO.</u>	<u>DESCRIPTION</u>
38	B2776	BAG HOLDER
39	B1472	RIGID SEAT BASE
40	B2784	SEAT PIVOT
41	B2990	PIPE, 3/4" X 154" - GALVANIZED
42	B1489	UPRIGHT BASE
43	B1490	ADJUSTMENT ARM
44	B1491	UPRIGHT
45	B2724	HORIZONTAL CONVEYOR SIDE
46	B1519	SPROCKET, 50TLB16
48	B1522	TAPER LOCK BUSHING, 1" BORE
49	B1529	3/4 POLYMER CSK HEAD RIVET (PKG OF 100)
50	B1968	BEARING BLOCK (REFER TO PAGE 3-48)
51	B5394	HYDRAULIC MOTOR, 4-BOLT ORB PORTS CLOCKWISE 1999 & LATER
	B5378	HYDRAULIC MOTOR, 4-BOLT ORB PORTS - PRIOR TO 1999
	B1658	HYDRAULIC MOTOR, 4-BOLT PIPE PORTS - PRIOR TO 1998
52	B1664	BEARING
53	B5125	CONVEYOR BELT, 24" X 266" OAL
54	B1667	HEAVY DUTY HITCH BALL
55	B1668	CONVEYOR BELT, 24" X 175" OAL
56	B1669	RUBBER TIRE IDLER
57	B1700	CASTER WHEEL AND TIRE ASSEMBLY
	B1697	CASTER WHEEL, HEAVY DUTY
	(*)B1771	HEAVY DUTY CASTER TIRE (20.5 X 8-10, LOAD RANGE E)
	D10100	VALVE STEM ASSEMBLY
58	B1609	HUB CAP
59	B1610	OUTER CONE
60	B1611	OUTER CUP
61	B1613	INNER CUP
62	B1705	CASTER WHEEL LUG BOLT
63	B2758	PIPE, 1/2" X 158" - GALVANIZED (OUTSIDE)
	B2766	PIPE, 1/2" X 121" - GALVANIZED (INSIDE)
64	B1614	INNER CONE
65	B2722	SORTING CONVEYOR FRAME
66	B2406	DOUBLE BRACE
67	B2785	CHAIN GUARD



WARNING - SHIELDS ARE FOR YOUR PROTECTION - KEEP THEM IN PLACE!

	D24	DECAL, BE CAREFUL
68	B2408	SINGLE BRACE

(*) REFERENCE ONLY, NOT FOR RESALE

BAG BANDING TRAILER SYSTEM, B722007, CONTINUED:

<u>KEY</u>	<u>PART NO.</u>	<u>DESCRIPTION</u>
69	X2A0370200	3/8-16 UNC X 2 CAP SCREW (LATCH)
70	B2410	OUTBOARD SUPPORT
71	B2411	UNLOADING CONVEYOR GUARD



WARNING - SHIELDS ARE FOR YOUR PROTECTION - KEEP THEM IN PLACE!

D24		DECAL, BE CAREFUL
72	B1591	PADDED SEAT
73	R10317	CLIPPER LACING WIRE X 36"
74	B1928	BEARING
75	R14184	SNAPPER PIN
76	B2780	REAR BAG HOLDER
77	B2441	LEFT TRAILER ATTACHING LEG
78	B2442	RIGHT TRAILER ATTACHING LEG
79	B2415	SEEDLING STOP
80	B2416	END COVER
81	B2781	FRONT GUIDE RAIL
82	B2782	REAR GUIDE RAIL
83	B2751	PIPE, 3/4" X 158"
84	B2716	BAG STAND
85	B2717	STAND PIVOT BASE
86	B1934	SPINDLE SEAL
88	X2L087-SLT	HEX SLOTTED NUT, 7/8-14 UNF
89	X3C088	SAE WASHER, 7/8
90	X3A15-175	COTTER PIN, 5/32 X 1-3/4
91	B2718	BOLT PAD

NOT SHOWN:

		SIGNODE PLASTIC STRAP BANDER
B2949		PLATE, BAFFLE BOLT
B2954		BAFFLE, RH

BAG SEWING TRAILER SYSTEM, B722009

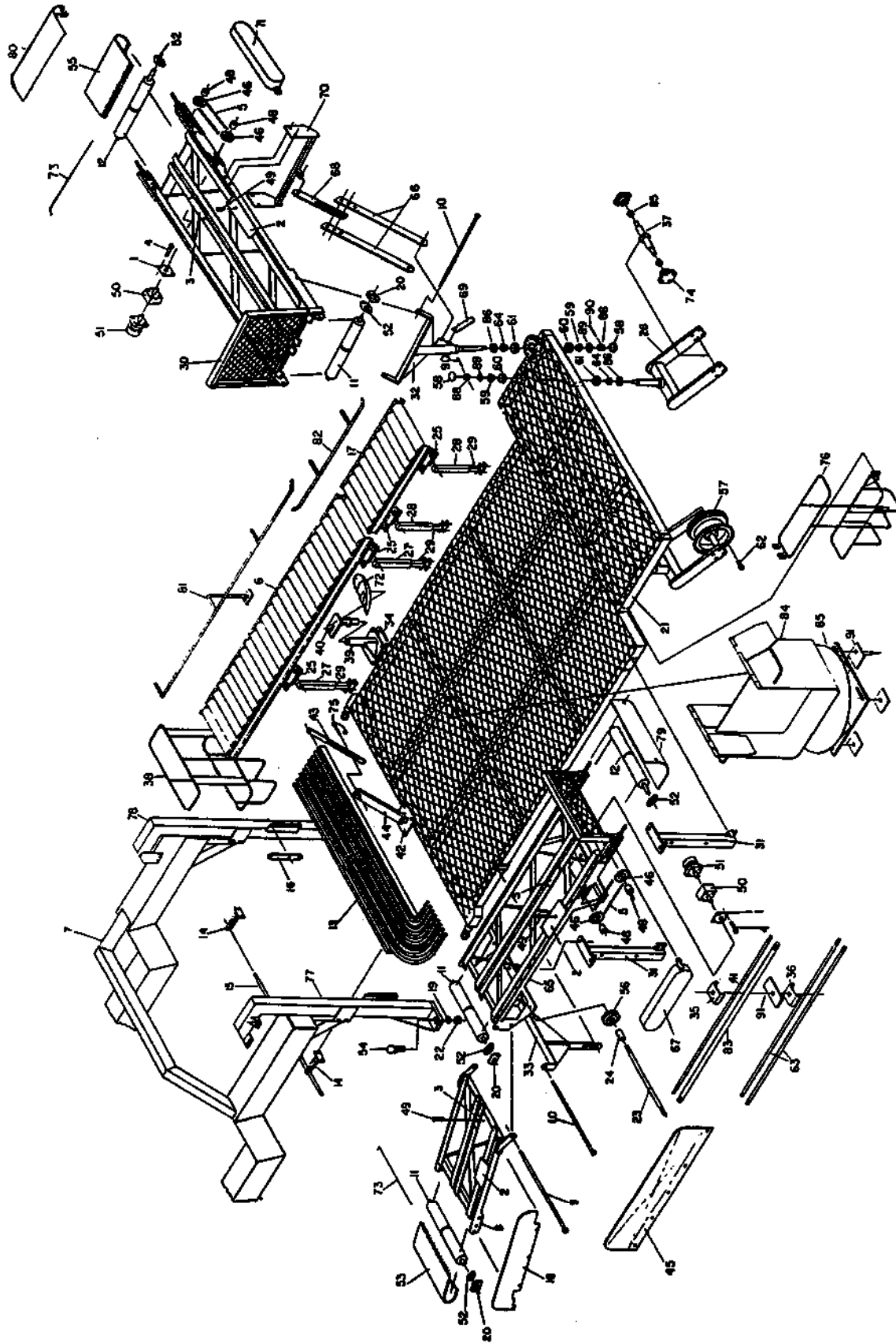

BAG SEWING TRAILER SYSTEM, B722009

<u>KEY</u>	<u>PART NO.</u>	<u>DESCRIPTION</u>
1	B2497	BEARING BLOCK SPACER
2	B1076	NYLATRON GS 1/8 X 4 WEAR STRIP (SPECIFY LENGTH, UNIT = 1")
3	B1077	NYLATRON GS 1/8 X 2 WEAR STRIP (SPECIFY LENGTH, UNIT = 1")
4	X2A0370400	CAP SCREW, 3/8-16 UNC X 4
5	A1671	RC 50 ROLLER CHAIN, BOX OF 10 FT
	B1815	OFFSET LINK
	B1816	CONNECTOR LINK
6	B2752	ROLLER TRACK, 15" X 90"
7	B2439	72" UNIVERSAL MAIL FRAME
8	B1407	INCLINED CONVEYOR FRAME
9	B1409	PIVOT PIN
10	B1410	PITCH LINK PIN
11	B1411	BELT IDLER PULLEY, 25-3/8"
12	B1412	BELT DRIVE PULLEY, 25-3/8"
13	B1420	TRANSVERSE GRATE
14	B1421	GRATE EXTENSION
15	B1422	EXTENSION ROD
16	B1423	VERTICAL ADJUSTMENT
17	B2753	ROLLER TRACK, 15" X 30"
18	B1432	INCLINED CONVEYOR SIDE
19	X3B125	LOCK WASHER, 1-1/4
20	B1439	CONVEYOR BEARING SPACER
21	B2721	BAG BANDING TRAILER FRAME
22	X2L125-NUT	HEX NUT, 1-1/4 - 12 THREAD
23	B1452	REVERSE BELT SUPPORT ROD
24	B1453	REVERSE BELT SUPPORT SPACER
25	B2754	TRACK BRACKET
26	B2432	FORK, TRAILER CASTER - STANDARD
27	B2755	LONG TRACK SUPPORT (2)
	B2915	LONG OFFSET SUPPORT (RIGHT) W/O CANOPY (2)
28	B2756	CONVEYOR SUPPORT BASE
	B2916	SHORT OFFSET SUPPORT (RIGHT) W/O CANOPY (2)
29	B2757	CONVEYOR SUPPORT BASE
30	B1459	UNLOADING CONVEYOR FRAME
31	B1460	CONVEYOR SUPPORT
32	B2443	UNLOADING CONVEYOR PIVOT
33	B2760	INCLINED CONVEYOR SUPPORT
34	B1467	SEAT PIVOT BASE CLAMP
36	B1469	PIPE CLAMP, 1/2 X 1/2
37	B2433	FORK AXLE
38	B2776	BAG HOLDER
39	B1472	RIGID SEAT BASE

BAG SEWING TRAILER SYSTEM, B722009, CONTINUED:

<u>KEY</u>	<u>PART NO.</u>	<u>DESCRIPTION</u>
40	B2784	SEAT PIVOT
41		NOT USED ON BAG SEWING TRAILER
42	B1489	UPRIGHT BASE
43	B1490	ADJUSTMENT ARM
44	B1491	UPRIGHT
45	B2724	HORIZONTAL CONVEYOR SIDE
46	B1519	SPROCKET, 50TLB16
48	B1522	TAPER LOCK BUSHING, 1" BORE
49	B1529	¾ POLYMER CSK HEAD RIVET (PKG OF 100)
50	B1968	BEARING BLOCK (REFER TO PAGE 3-48)
51	B5394	HYDRAULIC MOTOR, 3.2 cir 4-BOLT 1" SHAFT CLOCKWISE
	B5374	HYDRAULIC MOTOR, 4-BOLT ORB PORTS - PRIOR TO 1999
	B1658	HYDRAULIC MOTOR, 4-BOLT PIPE PORTS - PRIOR TO 1998
52	B1664	BEARING
53	B5125	CONVEYOR BELT, 24" X 266" O.A.L.
54	B1667	HEAVY DUTY HITCH BALL
55	B1668	CONVEYOR BELT, 24" X 175" O.A.L.
56	B1669	RUBBER TIRE IDLER
57	B1700	CASTER WHEEL AND TIRE ASSEMBLY
	B1697	CASTER WHEEL, HEAVY DUTY
	(*)B1771	HEAVY DUTY CASTER TIRE (20.5 X 8-10, LOAD RANGE E)
	D10100	VALVE STEM ASSEMBLY
58	B1609	HUB CAP
59	B1610	OUTER CONE
60	B1611	OUTER CUP
61	B1613	INNER CUP
62	B1705	CASTER WHEEL LUG BOLT
63	B2758	PIPE, 1/2" X 158" - GALVANIZED (OUTSIDE)
	B2766	PIPE, 1/2" X 121" - GALVANIZED (INSIDE)
64	B1614	INNER CONE
65	B2722	SORTING CONVEYOR FRAME
66	B2406	DOUBLE BRACE
67	B2785	CHAIN GUARD



WARNING - SHIELDS ARE FOR YOUR PROTECTION - KEEP THEM IN PLACE!

	D24	DECAL, BE CAREFUL
68	B2408	SINGLE BRACE
69	X2A0370200	3/8-16 UNC X 2 CAP SCREW (LATCH)
70	B2410	OUTBOARD SUPPORT
71	B2411	UNLOADING CONVEYOR GUARD

(*) REFERENCE ONLY, NOT FOR RESALE

BAG SEWING TRAILER SYSTEM, B722009, CONTINUED

KEY PART NO. DESCRIPTION



WARNING - SHIELDS ARE FOR YOUR PROTECTION - KEEP THEM IN PLACE!

	D24	DECAL, BE CAREFUL
72	B1591	PADDED SEAT
73	R10317	CLIPPER LACING WIRE X 36"
74	B1928	BEARING
75	R14184	SNAPPER PIN
76	B2780	REAR BAG HOLDER
77	B2441	LEFT TRAILER ATTACHING LEG
78	B2442	RIGHT TRAILER ATTACHING LEG
79	B2415	SEEDLING STOP
80	2416	END COVER
81	B2781	FRONT GUIDE RAIL
82	B2782	REAR GUIDE RAIL
83		NOT USED ON BAG SEWING TRAILER
84	B2716	BAG STAND
85	B2717	STAND PIVOT BASE
86	B1934	SPINDLE SEAL
88	X2L087-SLT	HEX SLOTTED NUT, 7/8-14 UNF
89	X3C088	SAE WASHER, 7/8
90	X3A15-175	COTTER PIN, 5/32 X 1-3/4
91	B2718	BOLT PAD

HYDRAULIC SCHEMATIC, BAG BANDING TRAILER
B722007

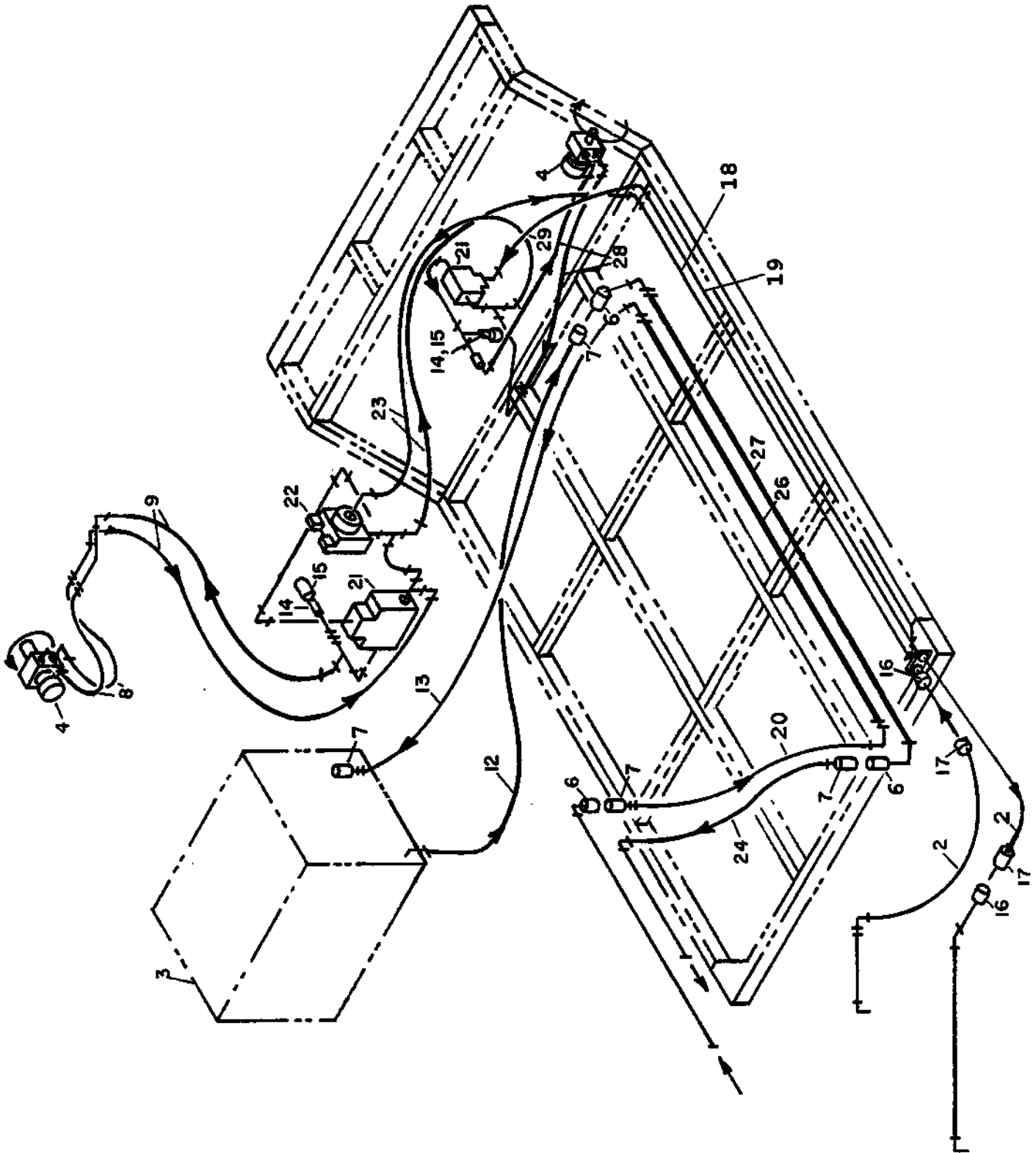

HYDRAULIC SCHEMATIC, BAG BANDING TRAILER B722007

<u>KEY</u>	<u>PART NO</u>	<u>DESCRIPTION</u>
1	B5546	HYDRAULIC MOTOR-GENERATOR ASSEMBLY
2	K1523	HOSE ASSY, 1/2" X 48" - #8 FJIC-100R1-1/2" NPTM (2)
3		SIGNODE BANDER, 3-PH 230 VOLT (NOT FURNISHED)
4	B5394	HYDRAULIC MOTOR, 3.2 cir 4-BOLT 1" SHAFT CLOCKWISE
	B5374	HYDRAULIC MOTOR, 4-BOLT ORB PORTS - PRIOR TO 1999
	B1658	HYDRAULIC MOTOR, 4-BOLT PIPE PORTS - PRIOR TO 1998
5	B5373	HOSE ASSY, 3/4" X 57" - 3/4" NPTM-100R1-#12 FJIC
6	B1654	3/4" QUICK DISCONNECT NIPPLE
7	B1653	3/4" QUICK DISCONNECT COUPLER
8	B1561	HOSE ASSY, 3/8" X 36" - #6 FJIC-100R1-#6 FJIC
	B1708	HOSE ASSY, 3/8" X 60" - #6 MJIC-100R1-#8 FJIC
10		
11		
12	B5366	HOSE ASSY, 3/4" X 38" - #12 FJIC-100R1-3/4" NPTM INLET, PRESSURE TO GENERATOR PACKAGE B5546
13	B5366	HOSE ASSY, 3/4" X 38" - #12 FJIC-100R1-3/4" NPTM (ON GENERATOR PACKAGE B5546)- OUTLET, RETURN
14	B1932	TEST PORT NIPPLE
15	B1936	DUST CAP
16	B1655	1/2" QUICK DISCONNECT NIPPLE
17	B1656	1/2" QUICK DISCONNECT COUPLER
18	B2766	PIPE, 1/2" X 121" - GALVANIZED (INSIDE)
19	B2758	PIPE, 1/2" X 158" - GALVANIZED (OUTSIDE)
20		
21	B5399	FLOW CONTROL VALVE W/RELIEF - SAE #10
22	VPH-3	SELECTOR VALVE, SAE - #8 ORB PORTS
23	B5009	HOSE ASSEMBLY, 1/2" X 120" - #8 FJIC-100R1-#8 FJIC
24	B1961	HOSE ASSEMBLY, 3/4" X 32" - #8 FJIC-100R1-3/4" NPTM
25	B5367	HOSE ASSEMBLY, 3/4" X 8" - #8 FJIC-100R1-3/4" NPTM
26	B2990	PIPE, 3/4" X 154"
27	B2751	PIPE, 3/4" X 158"
28	B1588	HOSE ASSY, 3/8" X 30" - #8 FJIC-100R1-#6 FJIC (2)
29	B5048	HOSE ASSY, 1/2" X 30" - #8 FJIC-100R1-#8 FJIC

HYDRAULIC SCHEMATIC, BAG SEWING TRAILER
B722009

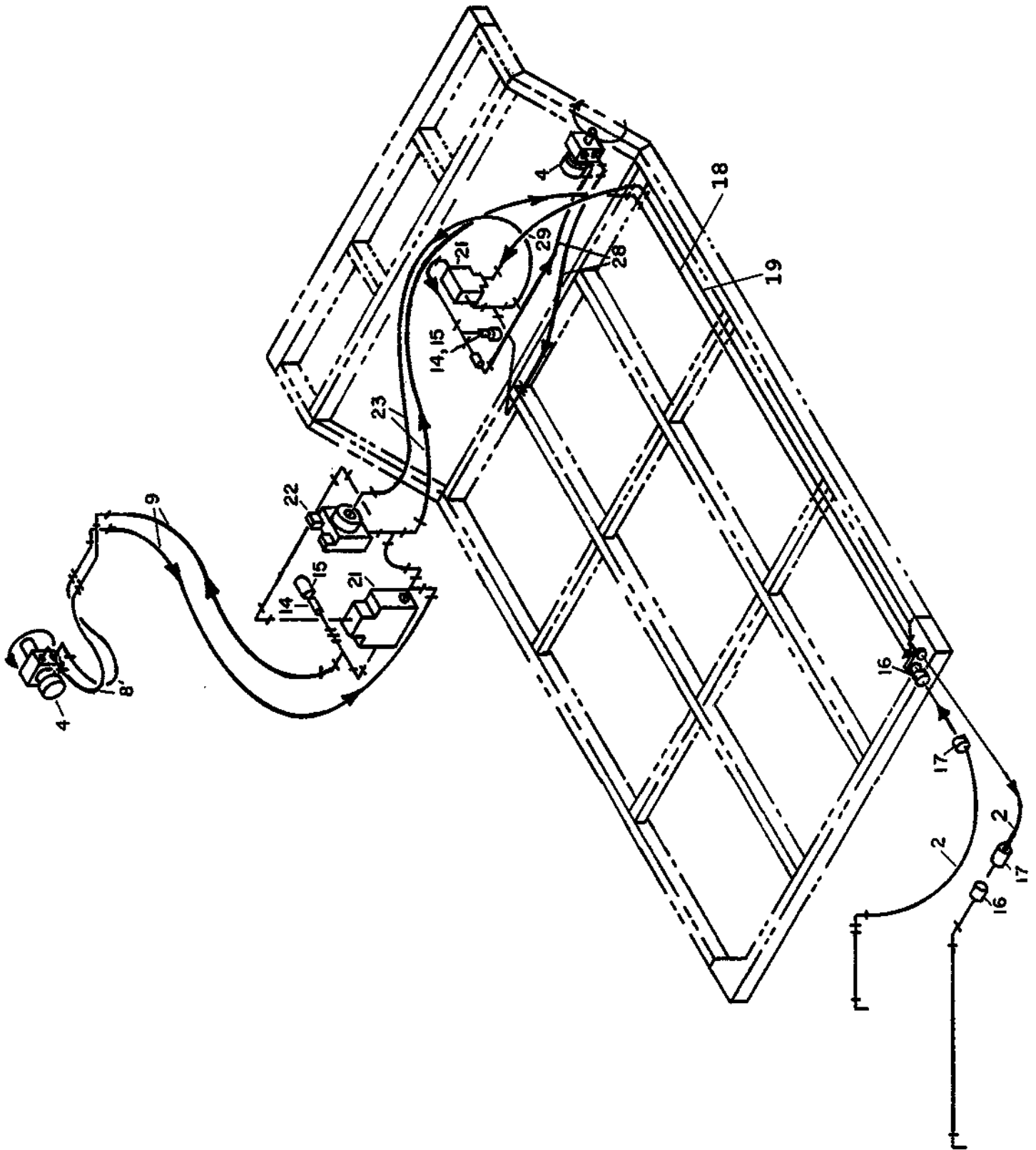

HYDRAULIC SCHEMATIC, BAG SEWING TRAILER B722009

<u>KEY</u>	<u>PART NO</u>	<u>DESCRIPTION</u>
2	K1523	HOSE ASSY, 1/2" X 48" - #8 FJIC-100R1-1/2" NPTM (2)
4	B5394	HYDRAULIC MOTOR, 3.2 cir 4-BOLT 1" SHAFT CLOCKWISE
	B5374	HYDRAULIC MOTOR, 4-BOLT ORB PORTS - PRIOR TO 1999
	B1658	HYDRAULIC MOTOR, 4-BOLT PIPE PORTS - PRIOR TO 1998
8	B1561	HOSE ASSY, 3/8" X 36" - #6 FJIC-100R1-#6 FJIC (2)
9	B1708	HOSE ASSY, 3/8" X 60" - #6 MJIC-100R1-#8 FJIC (2)
10		
11		
14	B1932	TEST PORT NIPPLE
15	B1936	DUST CAP
16	B1655	1/2" QUICK DISCONNECT NIPPLE
17	B1656	1/2" QUICK DISCONNECT COUPLER
18	B2766	PIPE, 1/2" X 121" (INSIDE)
19	B2758	PIPE, 1/2" X 158" (OUTSIDE)
20		
21	B5399	FLOW CONTROL VALVE W/RELIEF - SAE #10
22	VPH-3	SELECTOR VALVE, SAE - #8 ORB PORTS
23	B5009	HOSE ASSEMBLY, 1/2" X 120" - #8 FJIC-100R1-#8 FJIC (2)
28	B1588	HOSE ASSY, 3/8" X 30" - #8 FJIC-100R1-#6 FJIC (2)
29	B5048	HOSE ASSY, 1/2" X 30" - #8 FJIC-100R1-#8 FJIC

CANOPY PACKAGE, LONG TRAILER, FULL GABLE
B724004

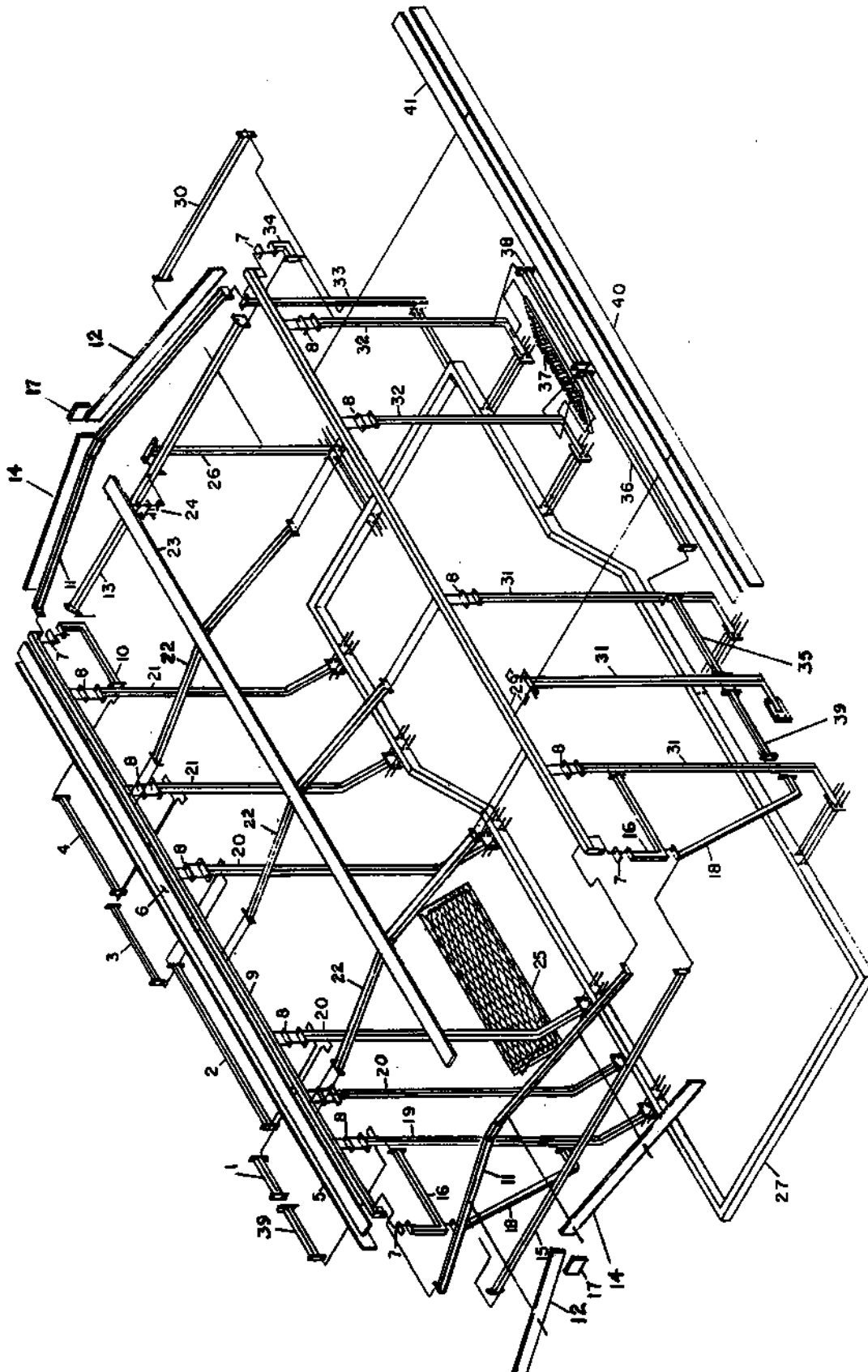

**CANOPY PACKAGE, LONG TRAILER, FULL GABLE
B724004**

<u>KEY</u>	<u>PART NO.</u>	<u>DESCRIPTION</u>
1	B2795	BRACE, 39"
2	B2736	BRACE, 67"
3	B2761	BRACE, 23-1/2"
4	B2737	BRACE, 25"
5 & 6		RIGHT TOP AND SIDE CORNER, CARPET COVERED - 3 PIECES
	B3093	CORNER, RIGHT FRONT TOP AND SIDE
	B3092	CORNER, RIGHT MIDDLE TOP AND SIDE
	B3091	CORNER, RIGHT REAR TOP AND SIDE
7	B2607	SINGLE HOLE RUBBER SHIM (4)
8	B2606	DOUBLE HOLE RUBBER SHIM (14)
9	B2866	RIGHT OUTSIDE TOP RAIL
10	B2864	RIGHT REAR TOP CORNER
11	B2886	TOP END CROSS MEMBER (2)
12, 14 & 17	B3094	FRONT AND REAR END CORNER, CARPET COVERED
13	B2727	REAR LOWER CROSS MEMBER
15	B2725	BOTTOM FRONT CROSS MEMBER
16	B2459	UPPER CORNER (2)
18	B2460	FRONT DIAGONAL (2)
19	B2732	RIGHT FRONT OFFSET POST
20	B2733	RIGHT MIDDLE OFFSET POST (3)
21	B2734	RIGHT REAR OFFSET POST (2)
22	B2887	TOP CENTER CROSS MEMBER (3)
23		CENTER TOP SUPPORT ASSEMBLY, CARPET COVERED - 3 PIECES
	B3105	TOP CANVAS SUPPORT (2)
	B3106	TOP REAR CANVAS SUPPORT
24	B2888	REAR BRACE
25	B2777	DECK EXTENSION. 67"
26	B2861	RIGHT REAR POST
27	B2721	BAG BANDING TRAILER FRAME
29	B2865	LEFT OUTSIDE TOP RAIL
30	B2779	BRACE, 48-1/4"
31	B2889	LEFT FRONT OFFSET POST (3)
32	B2890	LEFT REAR OFFSET POST (2)
33	B2862	LEFT REAR POST
34	B2892	LEFT REAR TOP CORNER
35	B2469	BRACE. 69-3/4"
36	B2735	BRACE 63-3/4"
37	B2778	DECK EXTENSION, 33"
38	B2471	BRACE. 33"
39	B2794	BRACE. 34-1/2" (2)
40 & 41		LEFT TOP AND SIDE CORNER, CARPET COVERED - 3 PIECES
	B3088	CORNER, LEFT FRONT TOP AND SIDE
	B3089	CORNER, LEFT MIDDLE TOP AND SIDE
	B3090	CORNER, LEFT REAR TOP AND SIDE
NOT SHOWN:	B1976	CARPET STRIP, 4" WIDE, UNIT = FOOT
	B1979	NYLON TIES, 0.031 X 13.38 BLACK (BAG OF 50)
	B5272	CANVAS COVER

MANUAL TRANSFER BULK HANDLING SYSTEMS, MESH CONVEYORS
B722008, LEFT HAND DISCHARGE SHOWN
B722010, RIGHT HAND DISCHARGE

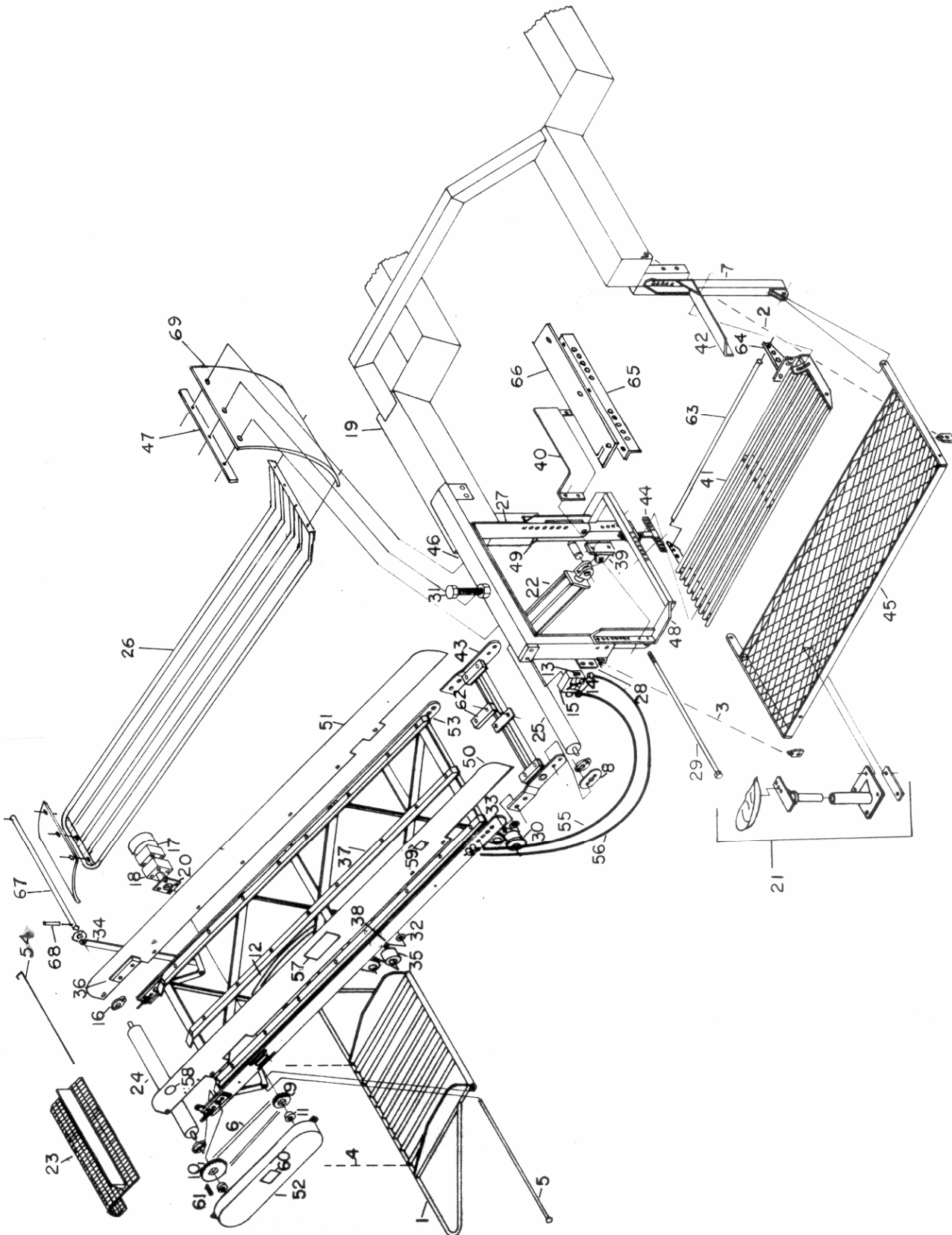

MANUAL TRANSFER BULK HANDLING SYSTEMS, MESH CONVEYORS
B722008, LEFT HAND DISCHARGE SHOWN
B722010, RIGHT HAND DISCHARGE

<u>KEY</u>	<u>PART NO.</u>	<u>DESCRIPTION</u>
1	B1068	DISCHARGE PAN
2	B1144	LONG SUPPORT CHAIN
3	B1145	SHORT SUPPORT CHAIN
4	B1148	PAN HANGER CHAIN
5	B1149	PAN HINGE PIN
6	A1671	RC50 CHAIN
	B1815	OFFSET LINK
	B1816	CONNECTOR LINK
7	B1322	TRANSFER STATION HANGER
8	B1439	SPACER, BEARING
9	B1519	SPROCKET 50 TLB 16
10	B1521	SPROCKET 50 TLB 22
11	B1522	BUSHING
12	B1588	HOSE, 3/8 X 30"
13	B1655	½ QUICK DISCONNECT NIPPLE, MALE 1/2" NPT
14	B5301	½ QUICK DISCONNECT COUPLER, MALE 1/2" NPT
15	B5399	FLOW CONTROL VALVE, #10 SAE - O-RING PORTS
16	B1664	CONVEYOR BEARING
17	B5393	HYDRAULIC MOTOR, COUNTER CLOCKWISE - O-RING PORTS
	B5374	HYDRAULIC MOTOR, 4-BOLT ORB PORTS - PRIOR TO 1999
	B1658	HYDRAULIC MOTOR, 4-BOLT PIPE PORTS - PRIOR TO 1998
18	B1968	BEARING BLOCK
		(REFER TO PAGE 3-48)
19	B2439	MAIN FRAME
	B2800	76"/72" UNIVERSAL MAIN FRAME
20	B2497	MOTOR SHIM
21	B1591	PADDED SEAT
	B1467	CLAMP
	B1472	BASE
	B2784	SEAT PIVOT
	X2Z0370175	3/8-16 UNC X 1-3/4 CAP SCREW
	X2C037	3/8-UNC HEX NUT
	X3B037	3/8 LOCKWASHER
	X3C037	3/8 FLAT WASHER
22	B5547	CYLINDER ASSEMBLY - SAE, CONVEYOR LIFT (2)
		(REFER TO PAGE 3-27)
	F1704	BREATHER PLUG, SAE ORB
	B5215	VELOCITY FUSE, SAE
	F3515	HYDRAULIC CYLINDER, 2" X 12" SAE
23	B2560	MESH CONVEYOR BELT ASSEMBLY
	B5086	FLAT WIRE BELTING
54	B5087	REPAIR PIN
	B5111	FLIGHT CLIP

MANUAL TRANSFER BULK HANDLING SYSTEMS, MESH CONVEYORS,

CONTINUED:

B722008, LEFT HAND DISCHARGE SHOWN

B722010, RIGHT HAND DISCHARGE

<u>KEY</u>	<u>PART NO.</u>	<u>DESCRIPTION</u>
	24 B2562	DRIVE PULLEY ASSEMBLY
	25 B2563	IDLER PULLEY ASSEMBLY
	26 B2564	HOLD DOWN ASSEMBLY
(47)	B2713	BELT CLAMP
	B2825	HOLD DOWN
(69)	B2826	BELT HINGE
	B2827	DISCHARGE FLAP
	B2974	CHAIN, HOLD DOWN SUPPORT
27	B2632	HANGER YOKE
28	B2641	GUIDE BLOCK
29	B2647	CONVEYOR PIVOT PIN
30	B2686	FLANGE IDLER PULLEY
31	B2687	CONVEYOR HEIGHT ADJUSTMENT SCREW
32	B2688	THRUST WASHER
33	B2691	BEARING JOURNAL
34	B2692	HOLD DOWN MOUNT
35	B2696	IDLER ROLLER
36	B2698	WEAR BLOCK (2)
37	B2701	WEAR STRIP (3)
38	B2703	SLEEVE SPACER, SHORT
39	B2705	CYLINDER MOUNT
40	B2706	LEFT KNEE GUARD
	B2821	RIGHT CONVEYOR KNEE GUARD
41	B2707	LEFT HAND TRANSVERSE GRATE
	B1305	RIGHT HAND TRANSVERSE GRATE
42	B2708	RIGHT TRANSFER GRATE SUPPORT
	B2807	LEFT TRANSFER GRATE SUPPORT
43	B2709	IDLER PULLEY HANGER, MESH CONVEYORS
44	B2710	HORIZONTAL ADJUSTMENT
45	B2583	LEFT HAND TRANSFER STATION ASSEMBLY
	B2584	RIGHT HAND TRANSFER STATION ASSEMBLY
	B2805	BAR, 32-1/4" (2)
	B2806	MANUAL TRANSFER DECK
46	B2712	LEFT CONVEYOR BEAM, HYDR MOUNT
	B2634	RIGHT CONVEYOR BEAM, HYDR MOUNT
47	B2713	BELT CLAMP
48	B2714	TRANSFER GRATE SUPPORT
49	B2720	TRANSFER STATION CYLINDER HANGER (FRONT)
	B2996	CONVEYOR CYLINDER HANGER (REAR)
50	B2748	CONVEYOR SIDE, LEFT HAND
51	B2747	CONVEYOR SIDE, RIGHT HAND

**B722008, LEFT HAND DISCHARGE SHOWN
B722010, RIGHT HAND DISCHARGE**

<u>KEY</u>	<u>PART NO.</u>	<u>DESCRIPTION</u>
52	B2749	CHAIN SHIELD, LH
53	B2629	CONVEYOR FRAME, MESH CONVEYOR
54	B5087	REPAIR PIN, MESH CONVEYOR
55	B5095	HOSE ASSEMBLY, 3/8" X 50"
56	B5096	HOSE ASSEMBLY, 3/8" X 60
57	D1	DECAL, LOVE - LARGE
58	D065	DECAL, 10 HR ZERK
59	D28-1	SERIAL NUMBER TAG



WARNING - SHIELDS ARE FOR YOUR PROTECTION - KEEP THEM IN PLACE!

60	D24	DECAL, BE CAREFUL
61	R14287	KEY, 1/4" SQUARE X 1-1/2" (2)
62	B2702	WEAR STRIP, 6"
63	B2815	EXTENSION ROD (3)
64	B2993	GRATE EXTENSION, SIDE CONVEYOR
65	B2828	ANGLE
66	B2829	CONVEYOR FLAP, LH
	B2831	CONVEYOR FLAP, RH
67	B2693	HOLD DOWN UPPER MOUNT
68	X3G0250-200	SPRING PIN, 1/4 X 2" (2)

NOT SHOWN:

B3057	CHAIN HOOK, LEFT HAND
B3058	CHAIN HOOK, RIGHT HAND
B5268	THREE WAY SOLENOID VALVE
B5322	NEEDLE VALVE
B5376	HOSE ASSEMBLY, 1/2" X 39" - #8 FJIC X 100R1 X #8 FJIC
B5522	CONTROL CONSOLE WITH CABLE